

# Connecting for the first time

## 1. MyKokoon app

Install and open the MyKokoon app.



## 2. Charging

Connect the headphones to a power source, using the USB-C cable.

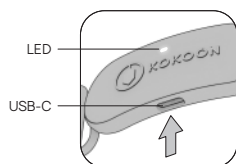

## 3. Powering on and Pairing\*

To turn the headphones on and enter pairing mode, hold the **○** button until the LED flashes blue.

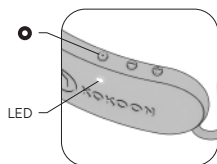

Turn on Bluetooth® on your phone. Select "Kokoon Nightbuds" in your Bluetooth® settings.

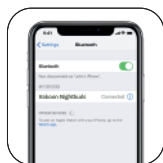

\*Before powering on and pairing, the device must be off.

\*Pairing only required for first connection.

For further information go to:  
[help.kokoon.io](http://help.kokoon.io)

# LED indicator

	Flashing	Single pulse
<b>White</b>	Powering off	Powering on
<b>Green</b>	Charging	Fully charged
<b>Blue</b>	Pairing mode (ready to pair with a new device)	Connected

## Action summary

### General

On / Off	Press <b>○</b> for ~2 sec
On + Pairing	Press <b>○</b> for ~5 sec
Volume up	Single click <b>+</b>
Volume down	Single click <b>-</b>
Charging status	Connect to power source Single click <b>○</b> , when charging Disconnect from power source

### Using app or media

Play / Pause	Single click <b>○</b>
Skip forward	Double click <b>+</b>
Skip backward	Double click <b>-</b>

### Incoming call or in a call

Reject call / End call	Press <b>○</b> for 1 sec
Answer call	Single click <b>○</b>

## Important care information

To maintain good sound quality, clean the acoustic nozzle regularly using an alcohol-based cleaner on a cotton bud. Clean the silicone sleeves with soapy water, rinse and dry thoroughly before re-assembly.

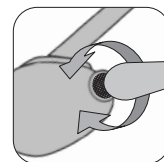

For further information go to:  
[help.kokoon.io](http://help.kokoon.io)



Your place to pause

# nightbuds

Experience sleep like never before

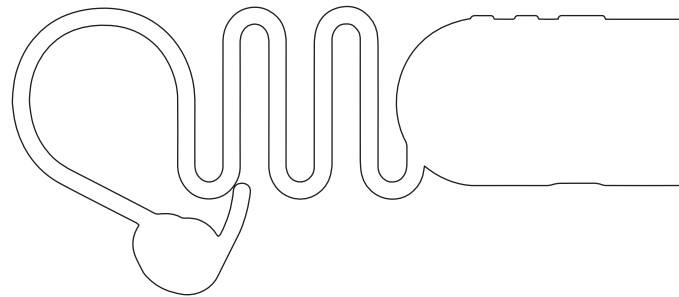

Quick start guide